

★安裝步驟 Installation Procedure

●1. 首先判斷如何將鋼管安裝在場景上，如使用 G01A、G02A、G03A 或 G06 吊輪，場景需有頂玻璃、頂牆身或兩邊牆身作支持，以確保鋼管可以穩固安裝在場景上。若缺乏上述條件，可選用 G05 吊輪作解決方案。

★1. Determine how to fix the track onto the scene. For roller G01A, G02A, G03A and G06, either masonry aside or overpanel is necessary, this is to ensure the track can be fitted onto the scene properly. However, if there's no masonry or overpanel, only roller G05A can be used.

●2. 將管夾水平固定在場景上，管夾相互間之距離為 475-485mm，首個管夾安裝位置距離管端 50mm。

★2. Fix the track holders onto the scene, distance between each track holders should be 475-485mm.

G10

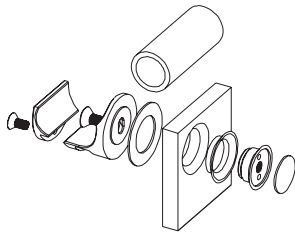

G10B

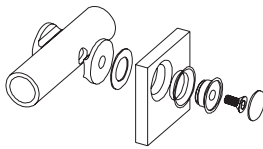

G11

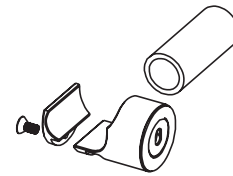

●3. 將 G07 或 G09 止動器套入鋼管，不需鎖緊定位螺絲。

★3. Insert the door stops onto the track without fixing them tight.

G07

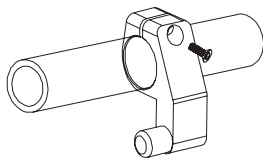

G09

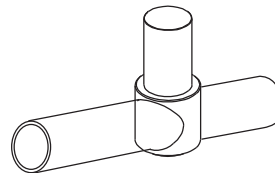

●4. 將鋼管固定在管夾上，並鎖緊管夾面蓋，以固定鋼管。

★4. Fix the track position with the fixed track holders.

●5. 將吊輪安裝在已預設開孔的玻璃門上，此時無需安裝穩定器及裝飾蓋。

★5. Install the rollers onto the movable glass door without assembling the stabilizer

For G01A, G02A & G03

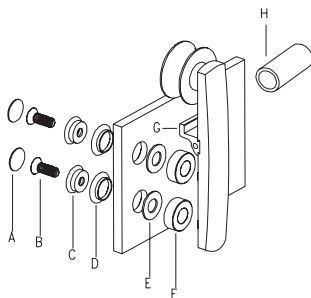

- A. Cover Cap
- B. Fixing Screw
- C. Fixing Nut
- D. Plastic Sleeve
- E. Plastic Washer
- F. Point Fixing For Glass
- G. Anti-Jump Stabilizer
- H. Track

For G05A

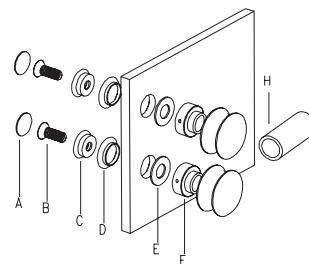

相關技術說明 Installation Procedure

- 6. 將玻璃門掛上鋼管，並以鉛筆記錄止擺器安裝位置。
- ★6. Hang the door onto the track and mark the corresponding position of the floor guide.
- 7. 確定止擺器安裝位置後，將玻璃門取下，在地上已記錄位置鑽孔，以安裝止擺器用。若使用木門 (G06系列)，木門底部必需先依指示開槽位。
- ★7. Remove the door and fix the floor guide with position marked. For timber door, a groove with size shown on template provided must be well-prepared.
- 8. 依玻璃門厚度調較 G08 止擺器上的黑膠調節器，凸位需轉向相應的刻度 (8, 10, 12, 13.5)，刻度已雕刻在金屬座底部。安裝止擺器，並確保軸承朝內 (適用於玻璃門安裝)。
- ★8. Adjust the plastic co-ordinator to the corresponding glass thickness with marking (8, 10, 12, 13.5) engraved on the metal stand. Install the floor guide and ensure ball bearing must be faced inward (for glass door only).

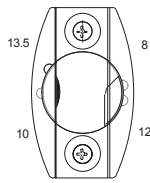
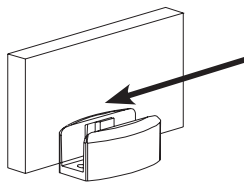

- 9. 掛上木門或玻璃門，校正位置後鎖緊吊輪上的收緊螺絲。
- ★9. Fit the door again, adjust the alignment of door and tighten up all the screws on roller.
- 10. 安裝吊輪上之穩定器。
- ★10. Install stabilizer onto the roller.
- 11. 調節止動器位置以鎖定玻璃門行程距離，並鎖緊止動器定位螺絲。
- ★11. Fix the position of door stops after confirmed the necessary travel distance
- 12. 用提供的雙面膠紙於吊輪後方貼上裝飾片。
- ★12. Stick the cover cap onto the back of roller by double tape provided.

★選擇性方案 Optional Solution

止動器 (雙頁式玻璃門專用)
Door Stop for Double Leaf Glass Door

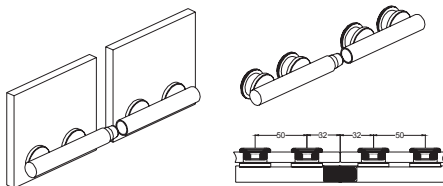

玻璃固定桿
Glass Connector

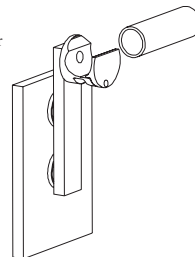

鋼管定位器 Connecting Sleeve

●若使用 G16 固定件系列時，在上述次序 3 前需將牆身固定件安裝，並在次序 3 與止動器一同套入鋼管，並將之安裝定位。

★If connecting sleeve G16 series is used, it's necessary to mount the fixing nut onto the wall before step 3. Insert the sleeve part with the door stoppers at step 3 and tighten all the screws on sleeve after fixing the track position.

安裝示樣 Illustration	型號 Model	功能 Usage
	G16	牆身相互配合 Wall to Wall Fixing
	G16A	玻璃與牆身配合 Wall to Glass Fixing
	G16B	玻璃相互配合 Glass To Glass Fixing